

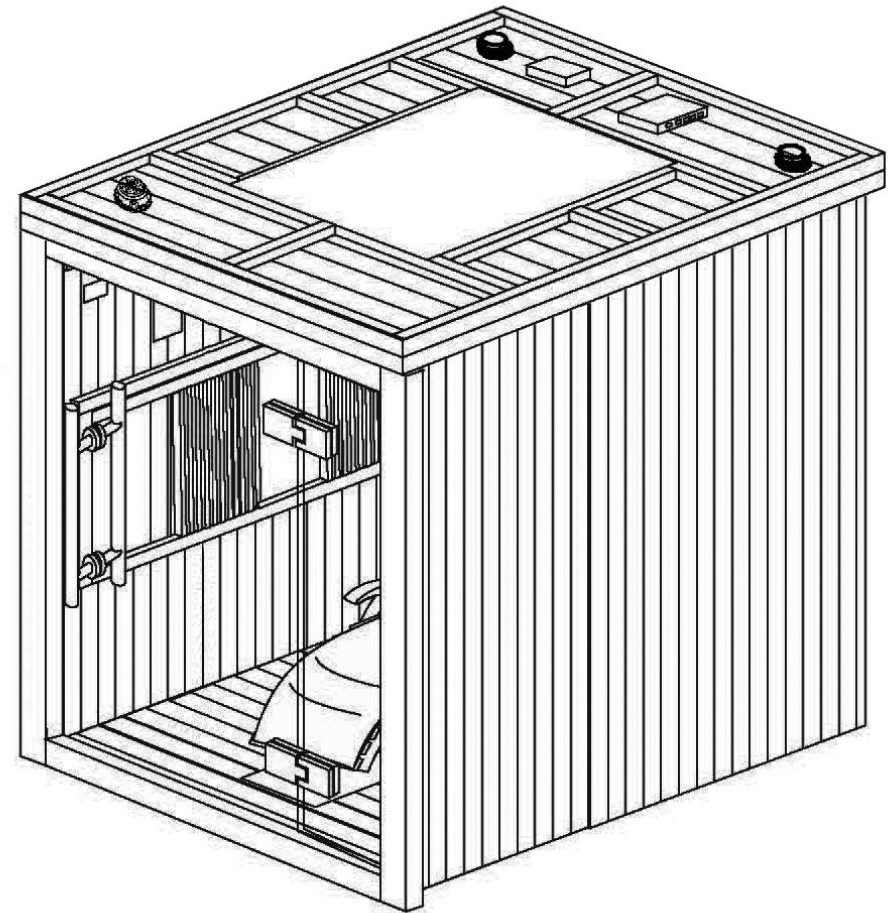

INSTALLATION MANUAL

KY900

Sauna Series



30 Day Technical Support:

Call **01908 317512** and request technical support for aiding your installation.

Replacements Parts: Inside of your warranty period visit:

<https://www.insigniashowers.com>, click support and make a warranty claim.

Spares/Replacements Parts: Outside of your warranty period visit

<https://www.insigniashowers.com/replacement-parts.html>

ATTENTION INSTALLERS:

These instructions must be
left with the customer

**CHECK ALL CONTENTS BEFORE BUILD COMMENCES. NO RETURNS CAN BE MADE
ONCE THE BUILD HAS STARTED AS IT IS DEEMED ACCEPTANCE OF PRODUCT!**

Contents

Thank you for your purchase	3
Electrical & Tool requirements	4
Box contents	5
Side Panel Connection	6
Left Side Panel to Back Panel Connection	7
Floor Positioning	8
Heater Cover Install	9
Seat Install	10
Right Side Panel Connection	13
Front Frame Install	14
Door Handle Install	15
Roof Install and Electrics Connections	16
Screwing the Roof into Position	17
Securing the Roof Wires into Position	18
Control Panel Instructions	19
Sauna Room Safety Guide	21
WEEE Compliance Statement	22



Thank you for your recent purchase of an Insignia Sauna. Please read this booklet with great care to ensure you get the best out of your build and have a Sauna that will last for many years to come! Like everything, in order to obtain a first class product that will serve you well for many years, the effort and correctness put into the assembly will reflect in the quality of your finish.

Electrical Requirements Model KY900

Voltage Rating 190-240AC

Frequency Rating 50Hz

Power Rating 2730 Watts

Amperage 11.4 Amps

Indoor saunas with power consumption under 3KW have been designed for easy installation, allowing for a simple plug-in directly into a standard household power circuit.

Installation Notes:

1. (Recommended) Consult with a qualified Electrician before connection to assess suitability.
2. Ensure all parts are connected safely and correctly.

Always use protection against electrical surges by means of an RCD unit.

If you are uncertain about the installation process or have any questions, please feel free to reach out to our friendly technical support for general advice. For anything more specific to the electric installation, please consult with a certified electrician.

Tools Required

- Scissors
- Knife
- Spirit Level
- Tape Measure
- Philips Screwdriver
- Electric Drill
- Safety Gloves
- Safety Glasses

What's in the Boxes?

Contents	Quantity	✓
Back Wall	1	[]
Floor	1	[]
Roof	1	[]
Side panel (two pieces)	2	[]
Side Panel Connectors (Top)	2	[]
Side Panel Connectors (Bottom)	2	[]
Seat	1	[]
Front Frame/Door	1	[]
Door Handle	1	[]
Heater Guard	2	[]
Screw Pack	1	[]

VERY IMPORTANT

Have you got everything? If not please contact the Insignia directly on **01908 317 512**. Remember **NEVER** book your tradesman until everything has arrived, been checked and is present. No replacement/missing parts can be obtained free of charge during or after the build. Any claims can only be within the timescale permitted (48 hours after delivery) and always **BEFORE** build.

Step 1 — Placing the side panel pieces together

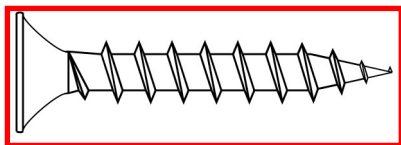

20 x 60mm Screws

The cut-outs are for the top of the panel, for the wires to slot through to the roof.

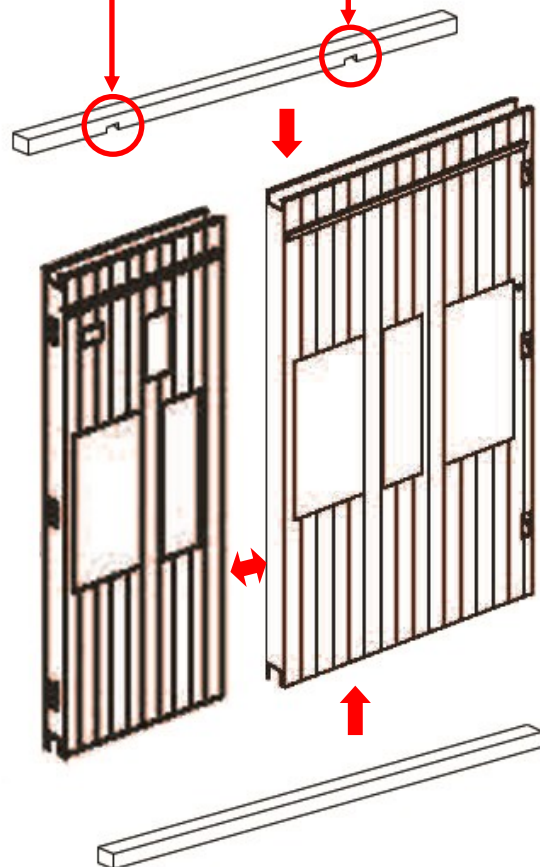

Slide the two panel pieces together and slot the top and bottom wood securing pieces in position.

Tip: Lay the panels flat on their back to connect.

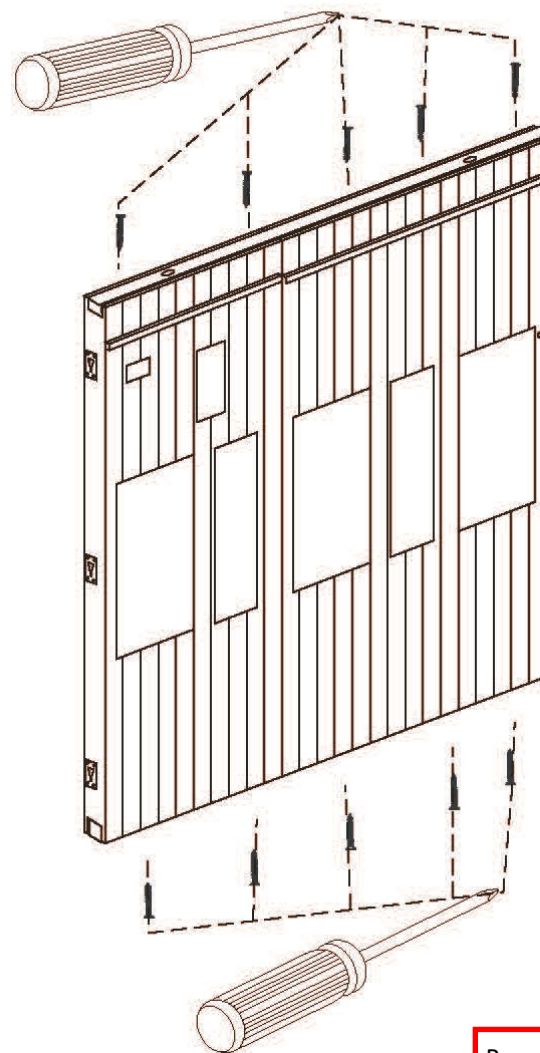

Repeat for the other side panel

Step 2 — Left side panel and back panel connection

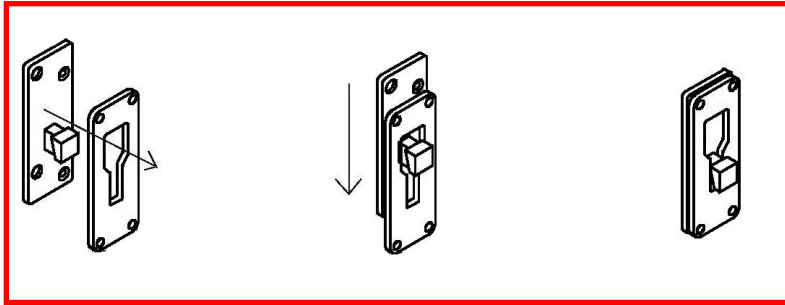

Lift the side panel, locate fixings and once connected, push down to secure into position.

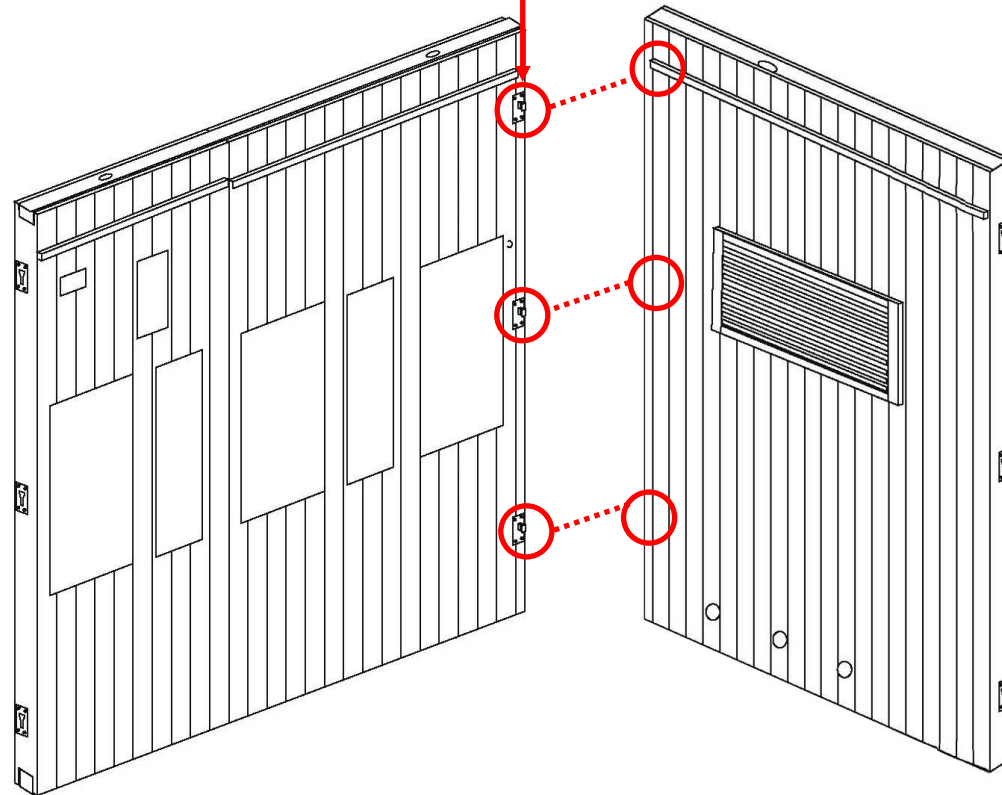

Step 3 — Slide the floor into position

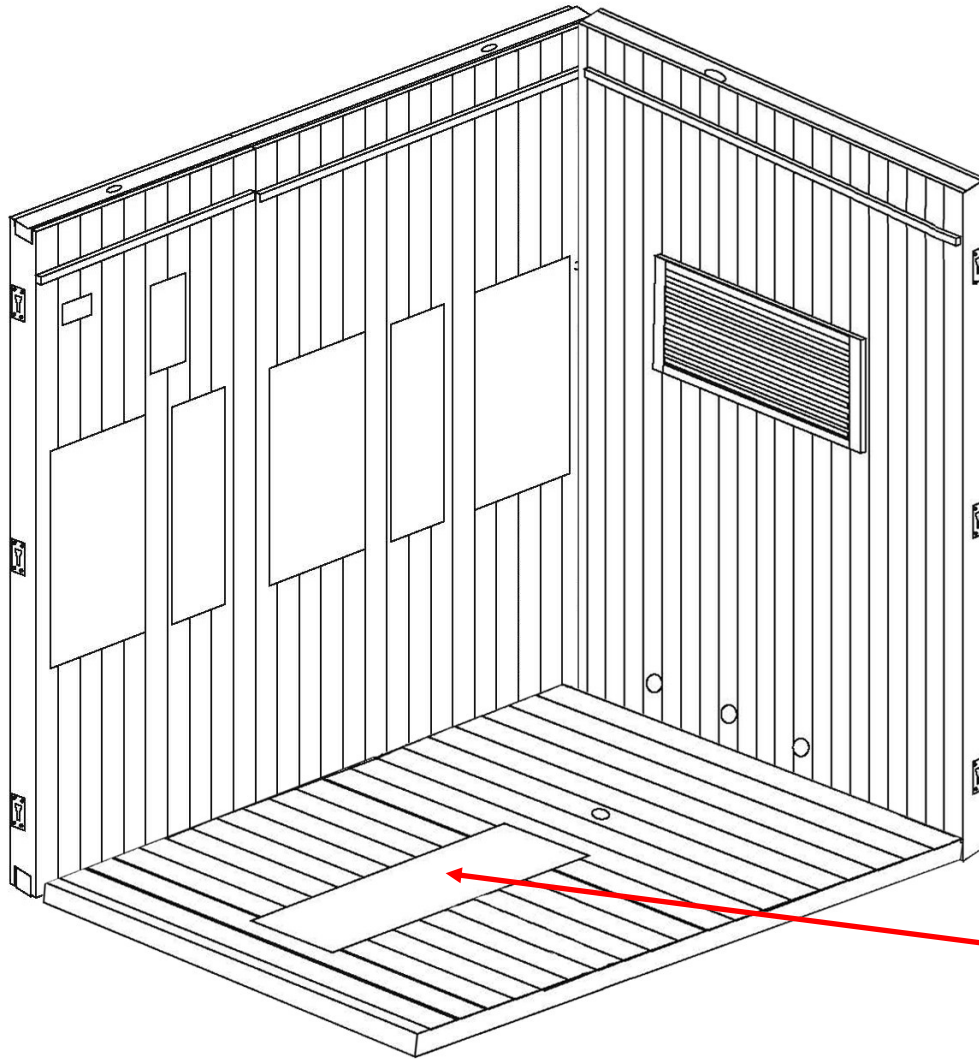

Ensure the plate heater is towards the front. Remove the wood securing it in position for transit and the packaging.

Step 4 — Installing the heater covers

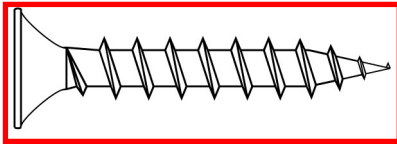

8 x 50mm Screws

Connect the lights then align the heater cover using a spirit level and connect screw in position using ST50 Screws

Do this for both sides.

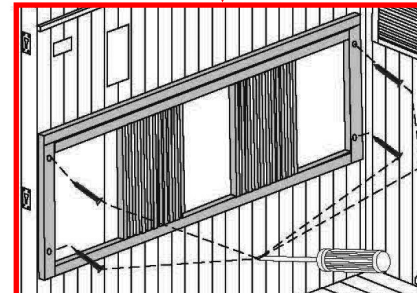
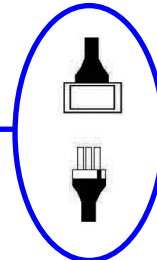
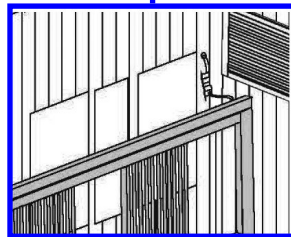
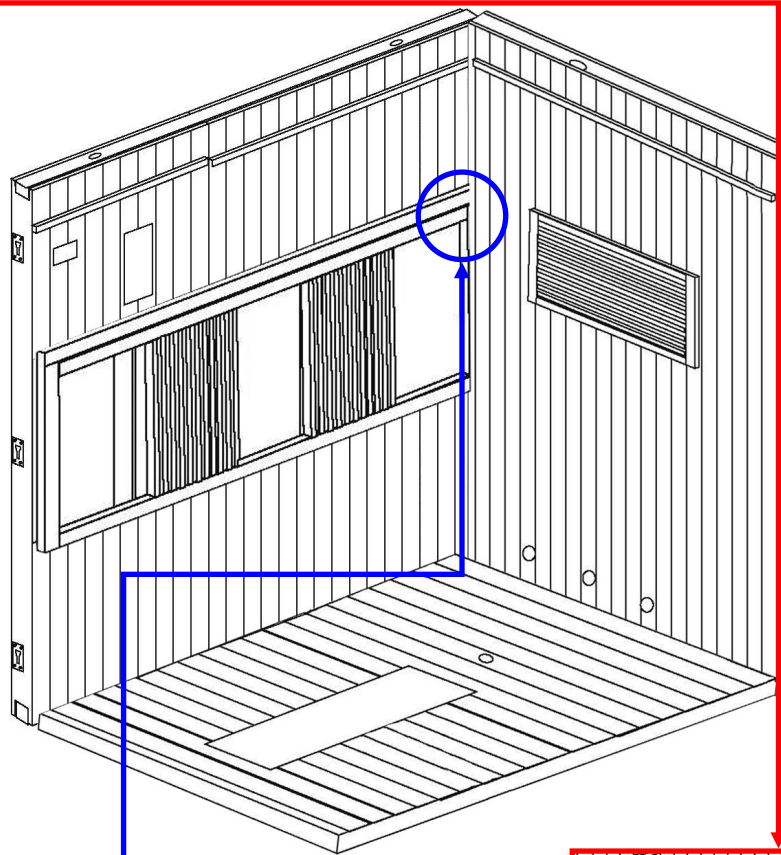

Step 5 — Installing the seat

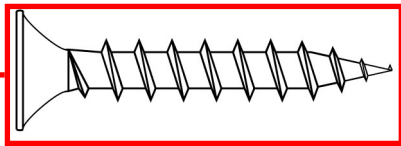

16 x 30mm Screws

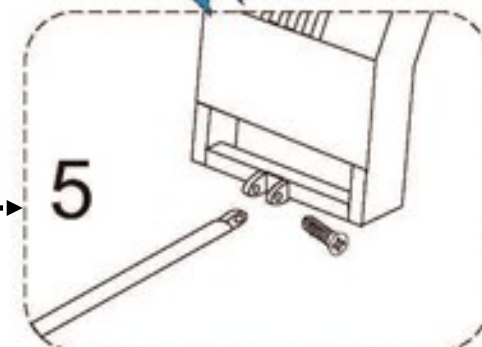
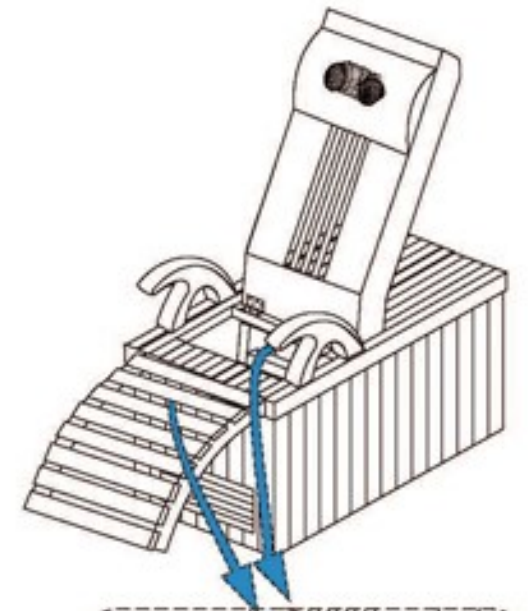
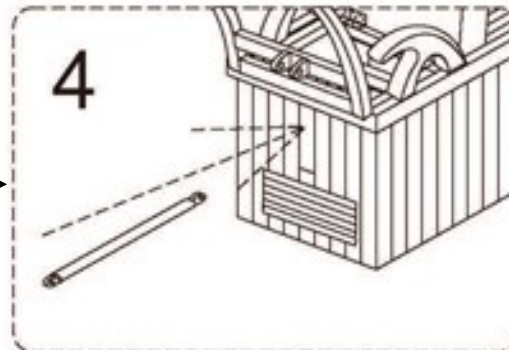
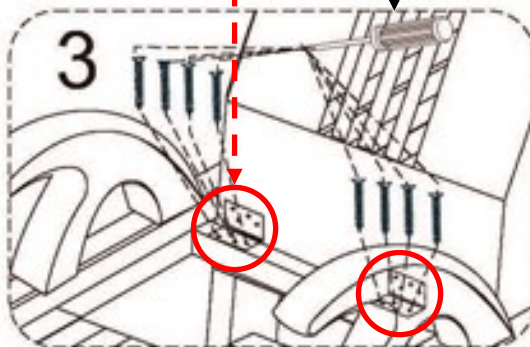
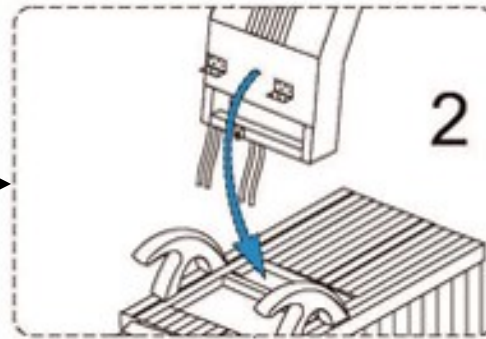
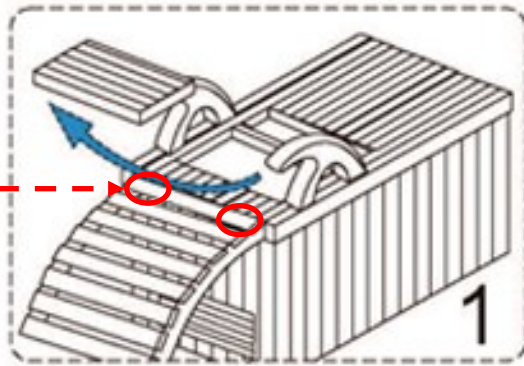

Step 6 — Installing the seat continued

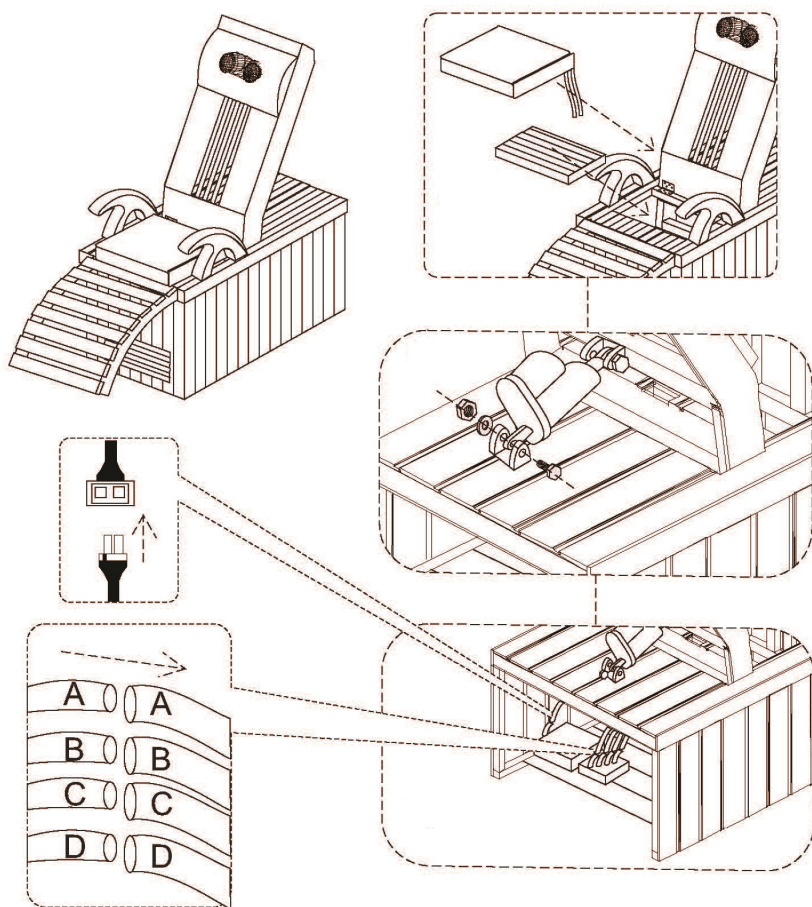

Firmly push all rubber hoses together

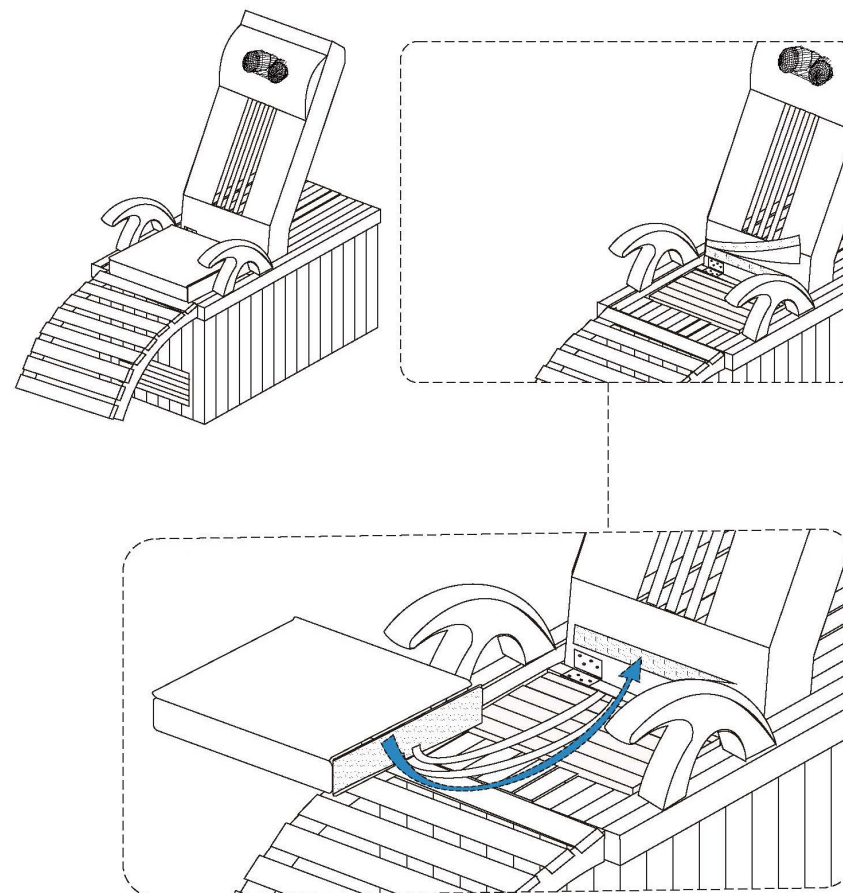

Step 7 — Seat electric connections

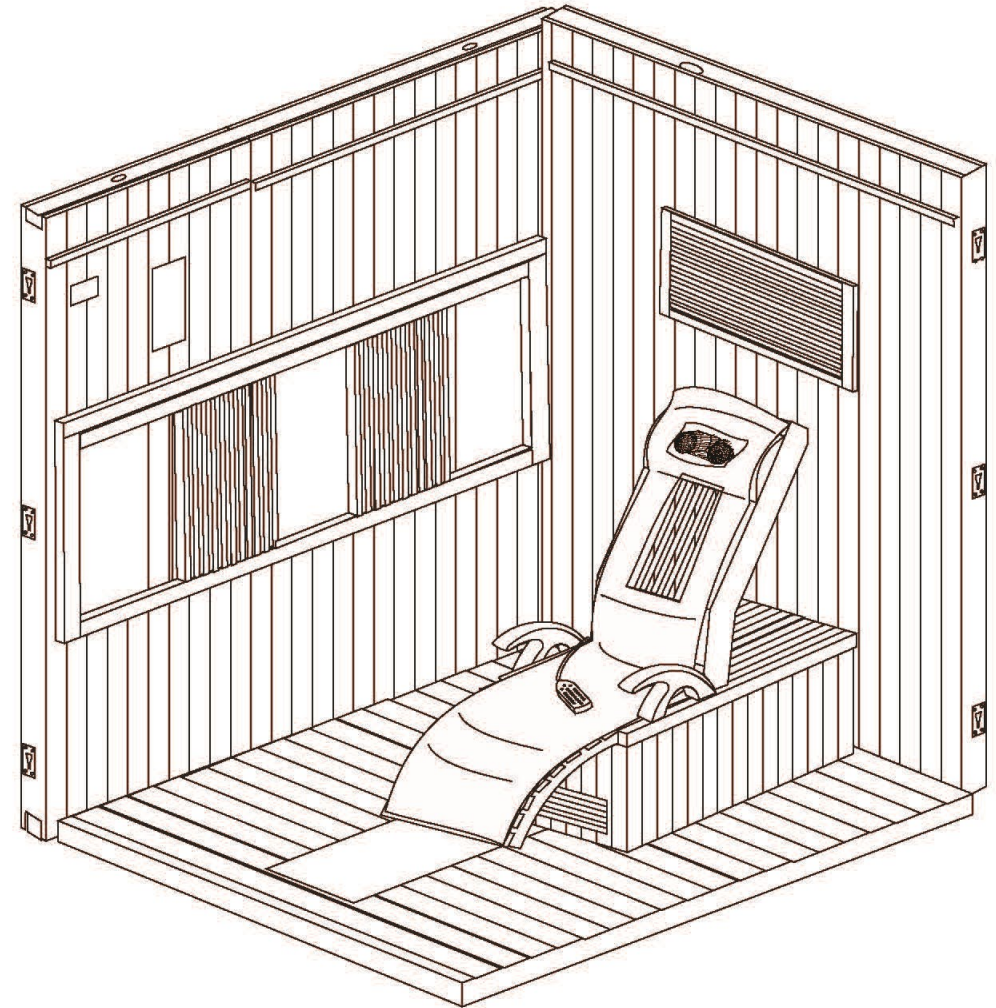
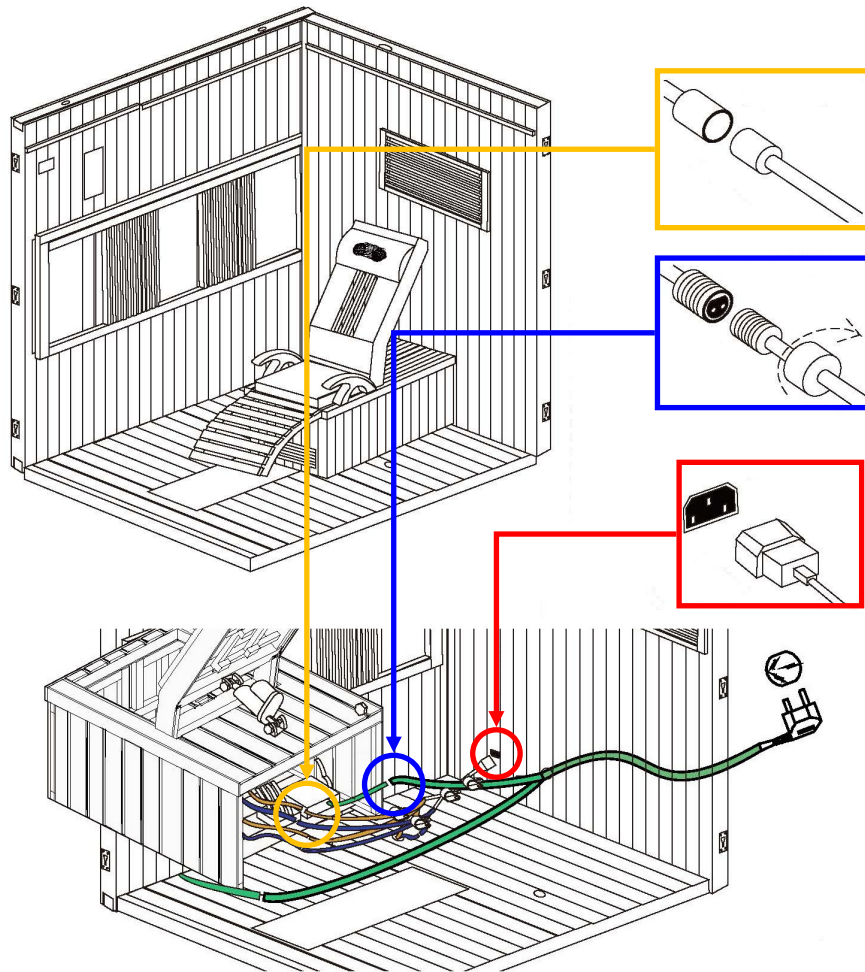

Connect all power from under both seats and then slide into position.

Step 8 — Right side panel install

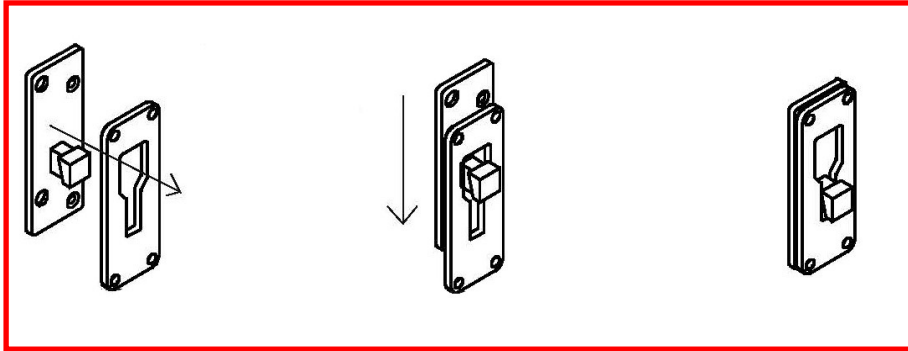

Lift the side panel, locate fixings and once connected, push down to secure into position.

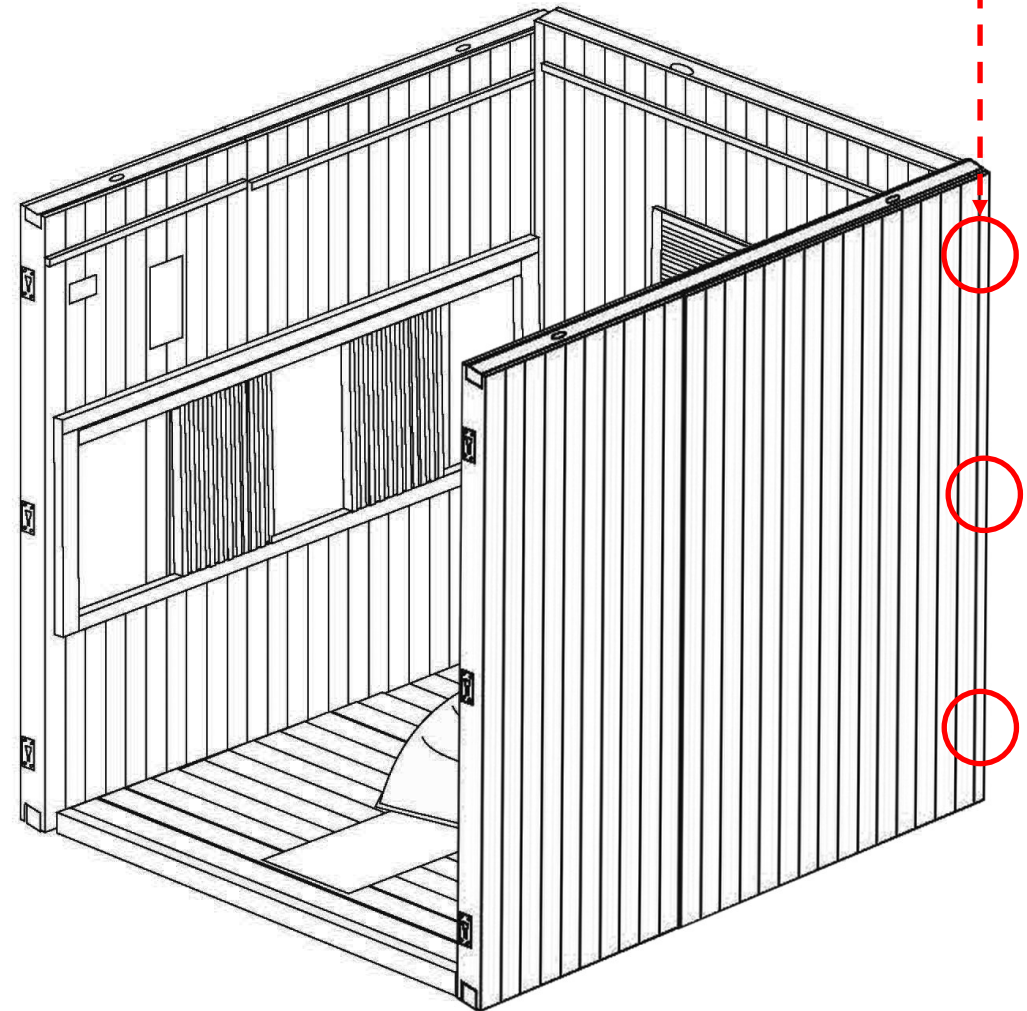

Step 9 — Installing the front framework

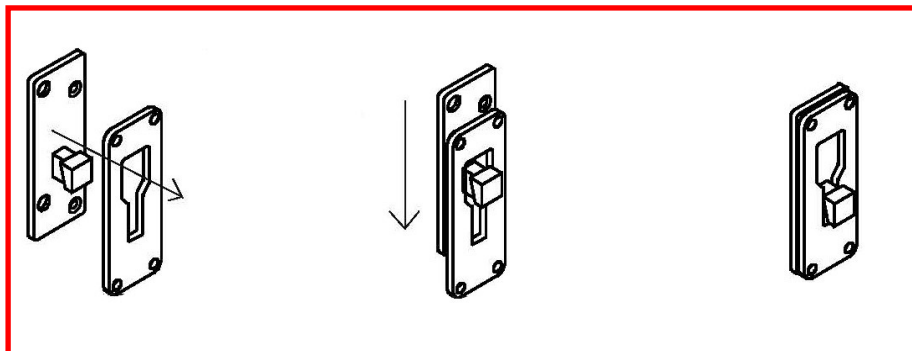

Lift the front frame, locate fixings and meet with each side panel then push down to secure into position.

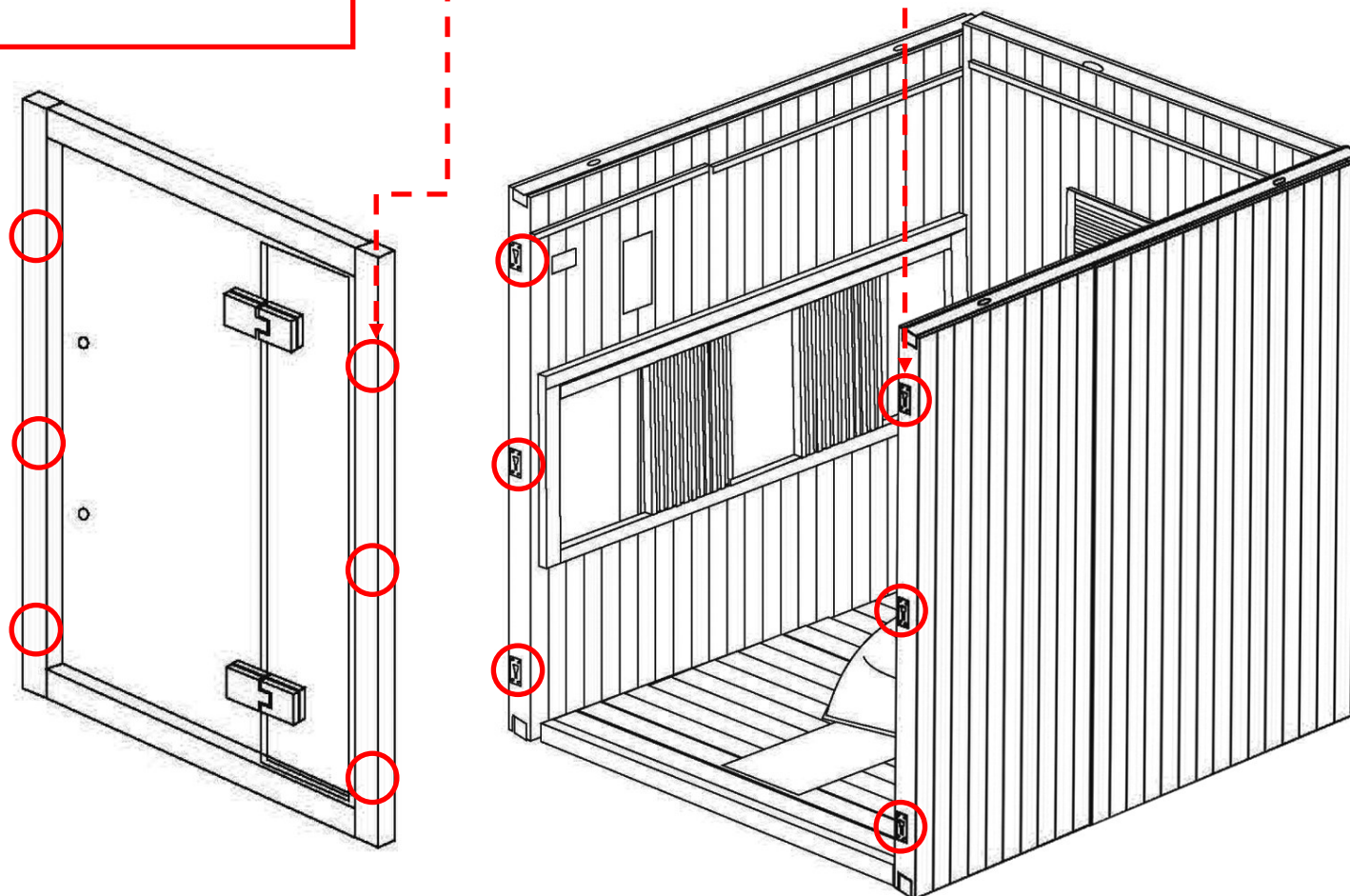

Step 9 — Installing the door handle and seals

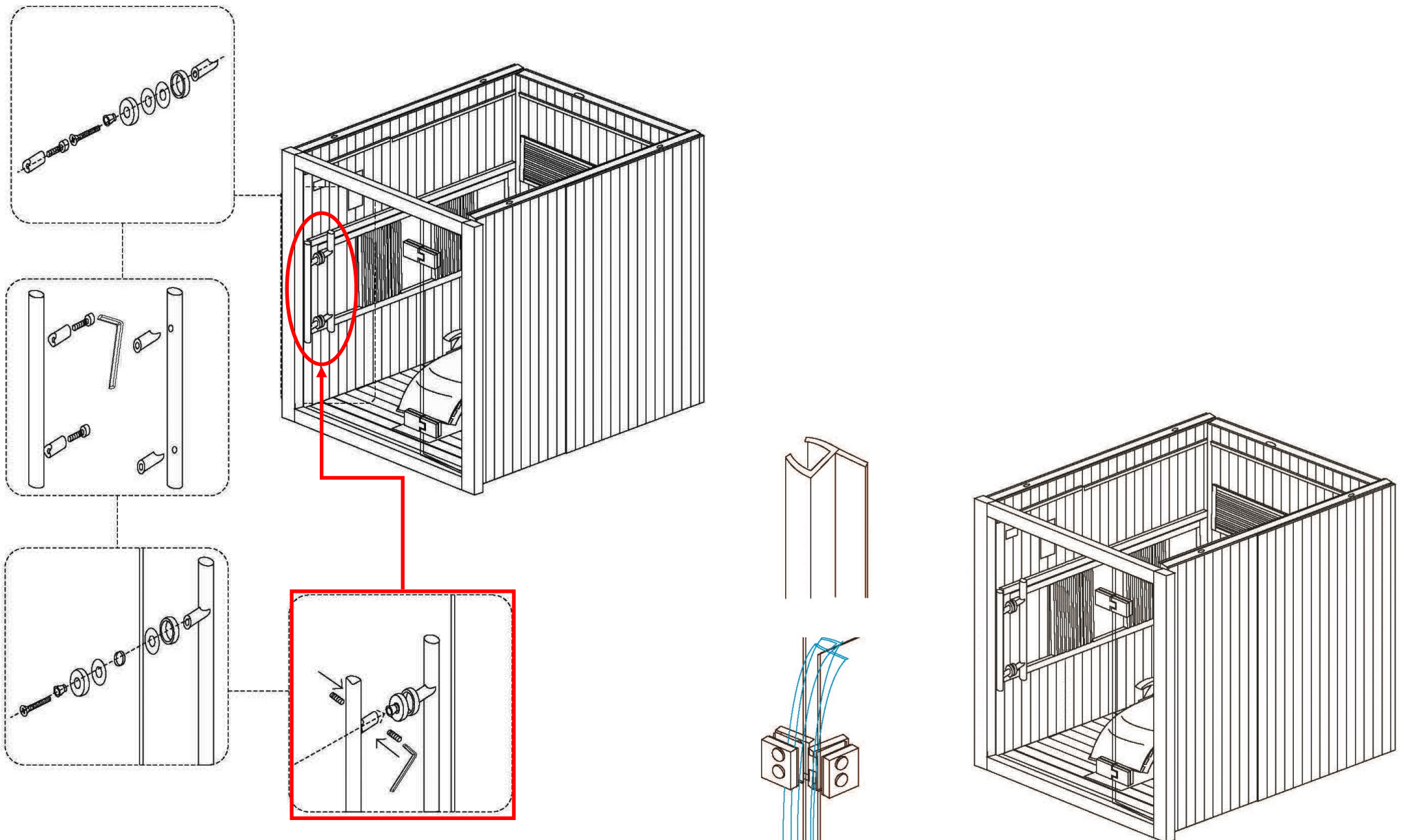

Step 9 — Installing the roof and connecting power

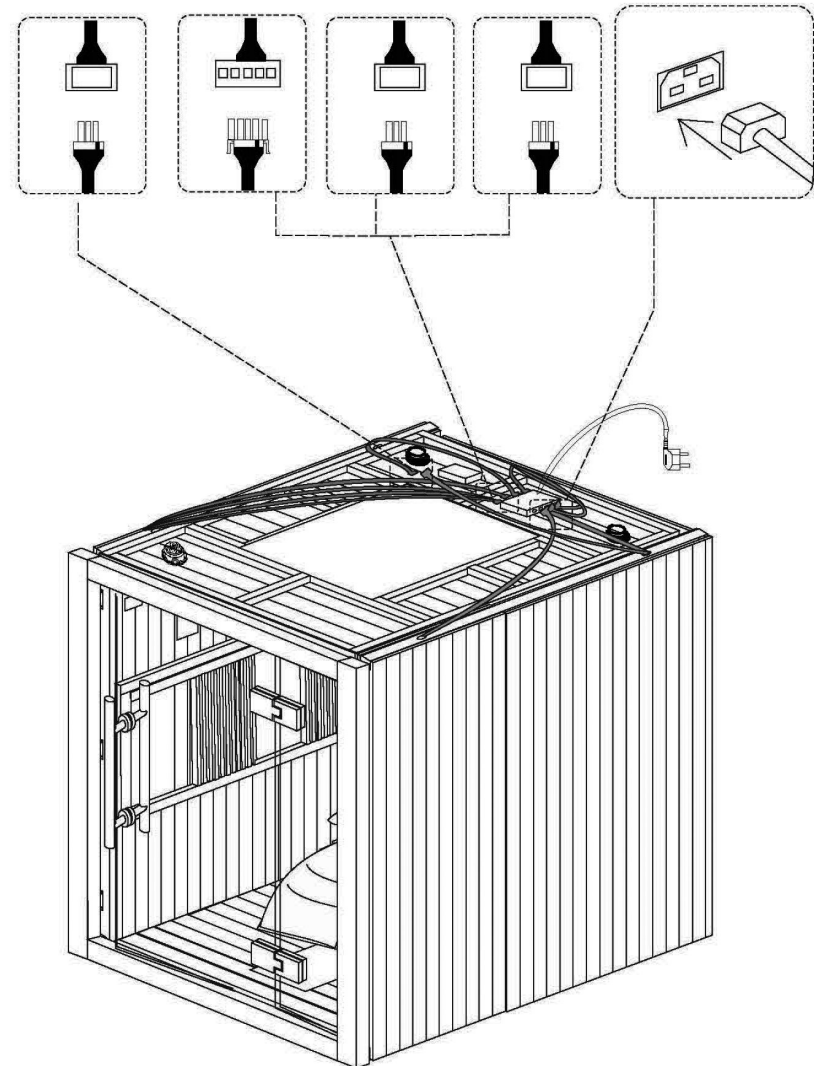
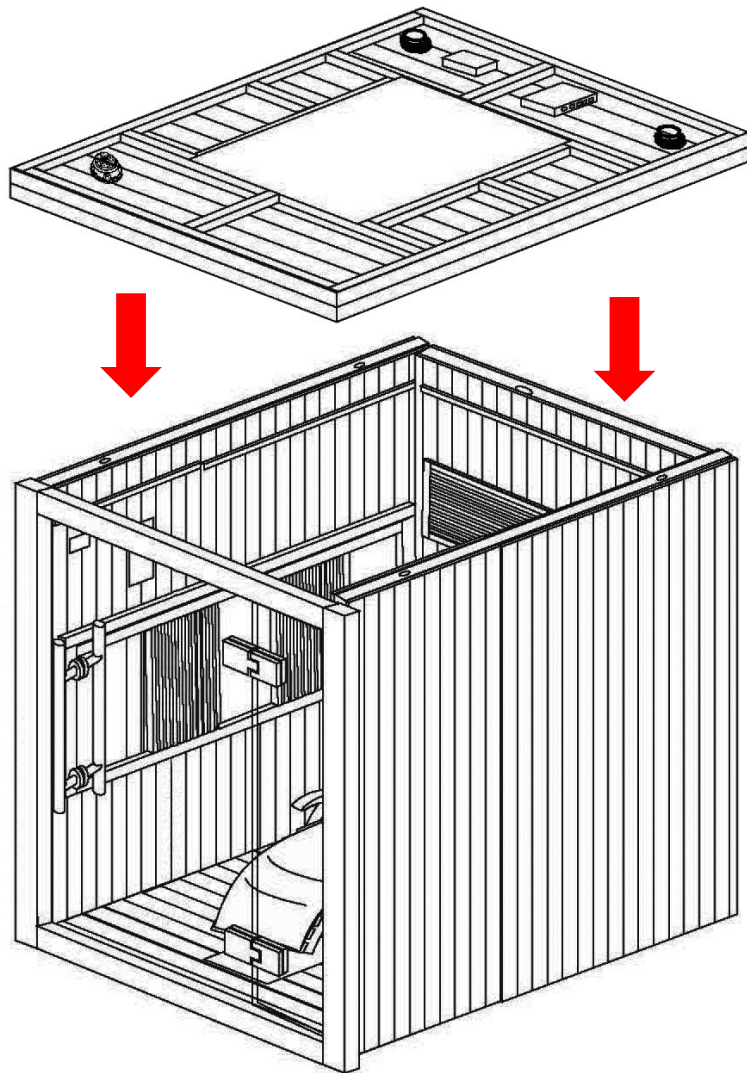

Step 9 — Securing the roof into position

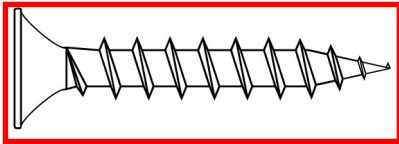

14 x 60mm Screws

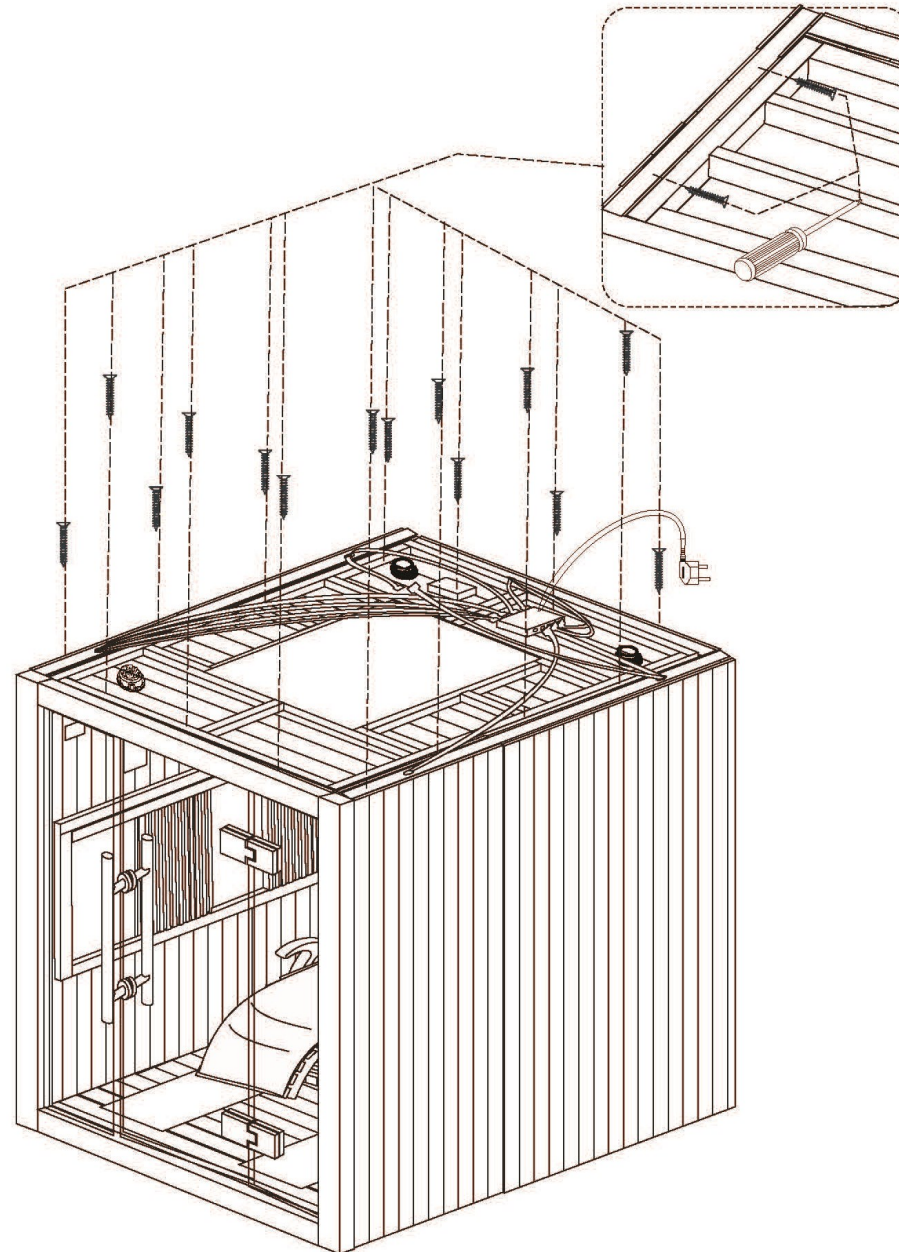

Step 9 — Securing the wires to the roof

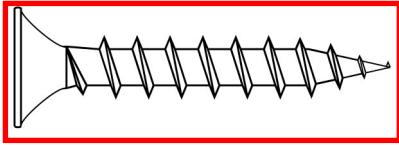

20 x 12mm Screws

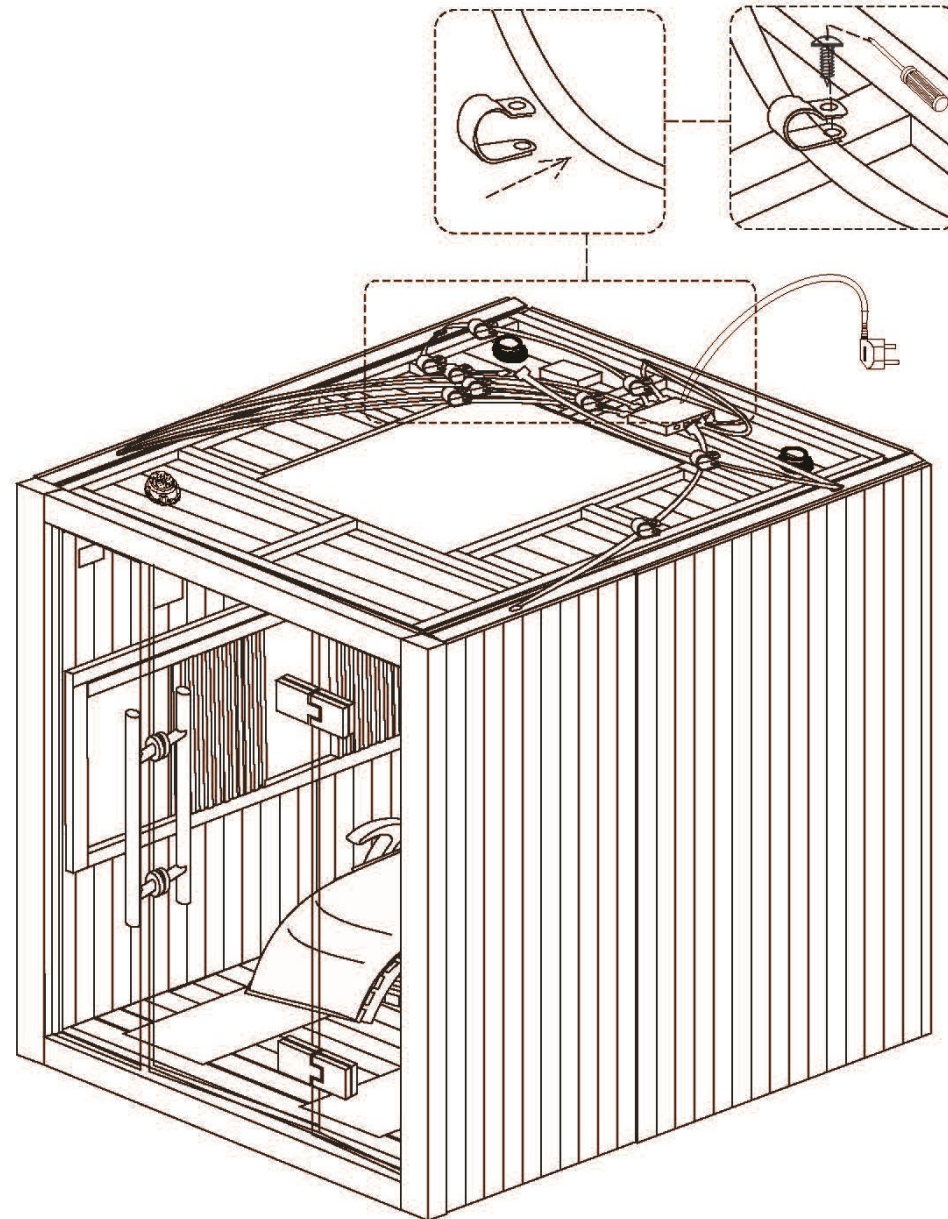

KY1500 (KY0721 BT Panel)

Control Panel Instructions

Button 1/2 (Sauna Heaters)

Press to activate Sauna heaters. Pressing once will put the heaters on at 100%. Twice = 90%. Three times = 80%. Four times = 70% and five times = Off.

Button 3(Lights)

Press to cycle through the coloured lights. Each press will change colour until a full cycle is completed and they turn off.

Button 4 (Fan)

Press to turn the fan on, press again to turn it off.

Button 5 (Time/Temp)

Press to display temp, then cycle through desired temperature setting (max 60°C) using up and down arrows (Buttons 6/8). Press again to display time, then cycle through desired time setting (max 99 mins) using up and down arrows (Buttons 6/8).

Button 6/8 (Up and Down Arrows)

Use to cycle up or down through various setting options.

Button 7 (Play/Pause/Memory)

Use to Play/Pause music through various settings. When searching and tuning the radio, use to save a desired frequency to a specific channel.

Button 9 (Set)

Press and use the arrows (Button 5/11) to manually search. Hold to tune radio stations automatically.

Button 10 (Audio Mode)

Press to cycle through the audio options, Radio/MP3/USB/Bluetooth or AUX. To connect the Bluetooth press the Audio function (Button 10) until 'BT' is shown on the control panel. Pair the sauna with your device. Once connected a tone will signify the connection has been successful and the Bluetooth icon showing on the panel interface.

Button 11 (Alarm)

Press to activate the alarm, press again to deactivate it.

Button 12 (Power)

Use to power the control panel on or off. Also use to unlock the panel (enters lock mode automatically after 60 seconds of inactivity).

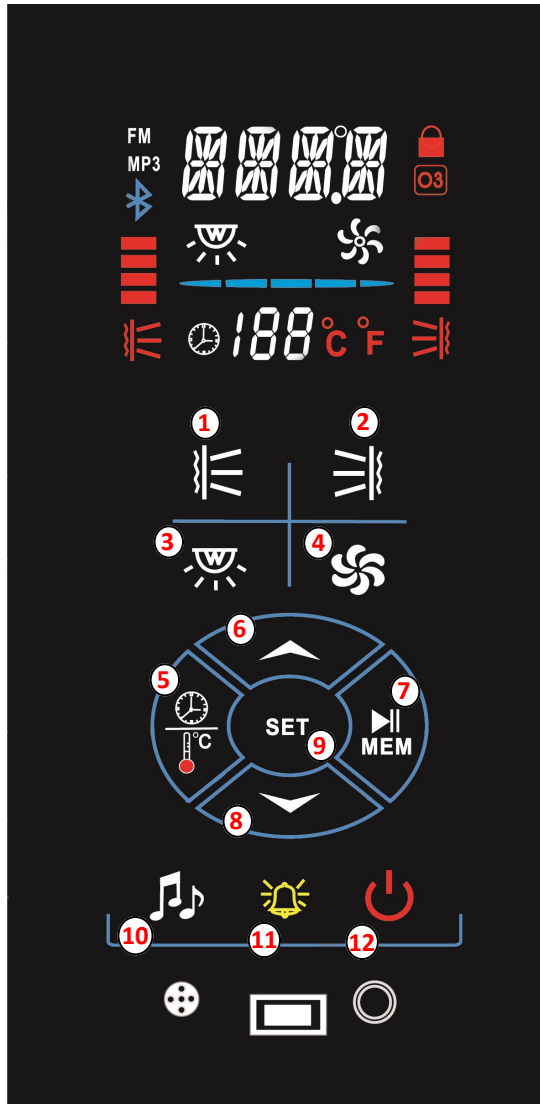

Chair Remote

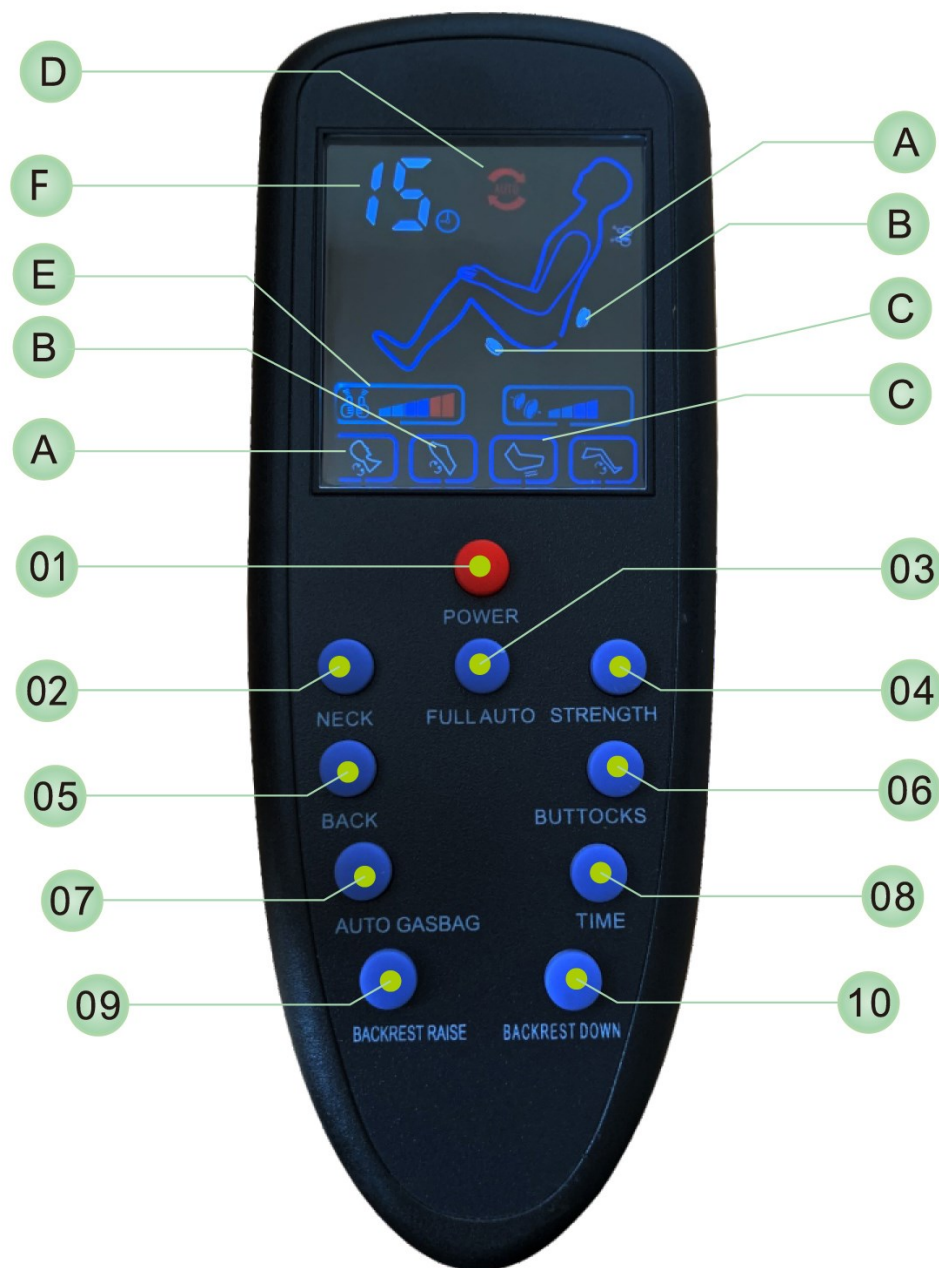

- | | | |
|---------------------|------------|----------------------|
| ① 【 Power 】 | ② 【 Neck 】 | ③ 【 Full auto 】 |
| ④ 【 Strength 】 | ⑤ 【 Back 】 | ⑥ 【 Buttocks 】 |
| ⑦ 【 Auto gasbag 】 | ⑧ 【 Time 】 | ⑨ 【 Backrest raise 】 |
| ⑩ 【 Backrest down 】 | | |

* Display

- | | |
|------------------------|-------------------------|
| Ⓐ 【 Neck massage 】 | Ⓑ 【 Back massage 】 |
| Ⓒ 【 Buttocks massage 】 | Ⓓ 【 Full auto massage 】 |
| Ⓔ 【 Strength 】 | Ⓕ 【 Time 】 |

Sauna Usage & Safety Guide

1. Never leave children unattended in the Sauna.
2. Regulate (if preferred) the temperature of sauna before session - Pre-heat time 15-30 minutes (from room temperature 20c)
3. Never touch the heater panels whilst in operation, possible burning may occur.
4. Recommended time of use is a maximum of 15 mins initially. We highly recommend working up in time to this, beginning with 5 minute sessions to get your body used to using a sauna.
5. Suggested operational heat range: Infrared—30° C-40° C. Infrared optimum use range 35°C to 40°C
6. Stay hydrated during each Sauna session.
7. Exit the sauna immediately if feeling dizzy, faint or short of breath.
8. Do NOT use the sauna if you're pregnant, have a heart condition, have low or high blood pressure. If you're unsure consult your GP before use.
9. If you have any underlying health conditions which you feel could be aggravated by an increase in temperature, consult your GP before use.
10. If you begin to have any issues with your health after using a sauna, stop immediately and consult your GP regarding your symptoms before continuing to use.
11. Consult your GP before using the steam room if you're on medication at all, especially with drowsy side effects.
12. Never use this sauna if you have been drinking alcohol or under the influence of other substances.
13. Do not put combustible material on the heaters at any time.
14. Always turn power supply off after use.

WEEE Compliance Statement

The UK Waste Electrical and Electronic Equipment (WEEE) regulations came into force on 2 January 2007. Under this new legislation, producers of electrical and electronic equipment (EEE) have to fulfil certain obligations.

Under the WEEE directive Insignia is considered the producer of certain products we supply and in line with the demands of the legislation we are pleased to offer the opportunity to return these products to us for treatment and recycling.

Insignia products will generally have an identifying mark and the common crossed out wheelee bin label. We accept returns of all products carrying the Insignia brand. All other products are either considered outside the scope of WEEE or Insignia is not technically the producer of these products. Insignia also accepts historic like-for-like WEEE returns. All WEEE returned to Insignia will be recycled in appropriate treatment and recycling centres in accordance with the legislation. If you wish to return any products to us, please send your item(s) to our head office.

Company Contract No. 326457

WEEE Producer No. CBDU64227

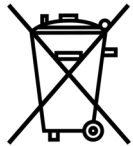

LABELING

Products labelled with the WEEE symbol (a crossed out “waste bin”) indicate that the final user should not discard this product along with other household waste, but that it must be collected and treated separately.



Returns Address for WEEE

Insignia

9a Deans Road, Old Wolverton, Canon Industrial Park, Milton Keynes, Buckinghamshire, MK12 5NA, UK



EU – Declaration of Performance

Insignia declares that all its products complies with the essential requirements and other relevant provisions of Directive 305/2011/EC. A copy of the Declaration of performance is available from www.insigniashowers.com/ce-certification

Insignia™ is a registered trademark of Maclean International Ltd, 9a Deans Road, Old Wolverton, Canon Industrial Park, Milton Keynes, Buckinghamshire, MK12 5NA, UK

All images are subject to copyright. Images may not be used in any way shape or form with out written permission from Maclean International Ltd. Images are NOT permitted to be saved, printed or uploaded. Violation of copyright laws are punishable by law.

All images are registered with
ImageTraker

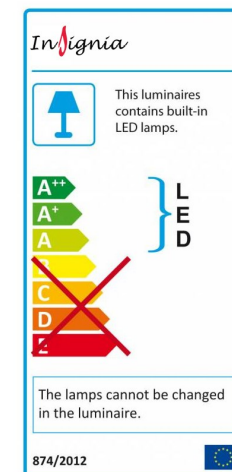

Insignia™ is a registered trademark of Maclean International Ltd

All images are subject to copyright. Images may not be used in any way shape or form with out written permission from Maclean International Ltd. Images are NOT permitted to be saved, printed or uploaded. Violation of copyright laws are punishable by law.